

MdB= 3500 Nm - MdG= 5000 Nm

Ingombro Rotazione 122 mm

Esecuzione Cod 46 Allungamento Standard La=100 mm	Tubo d6+S 76.2x2.41 / 88.9x2.41
---	------------------------------------

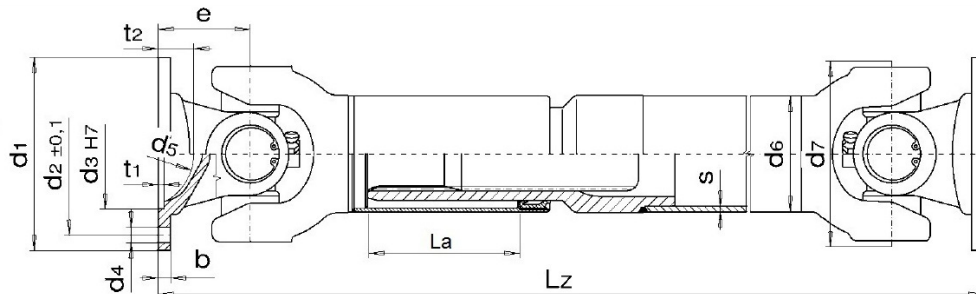

Esecuzione Codice 56 Alto Allungamento La=250 mm	Tubo d6+S 76.2x2.41 / 88.9x2.41
--	------------------------------------

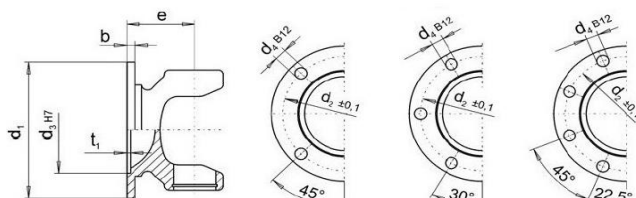
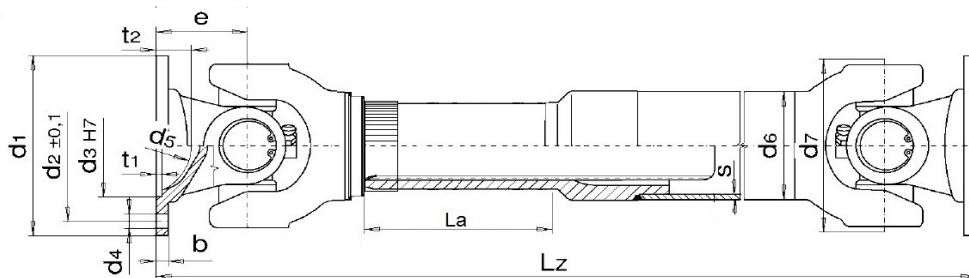

Fig. 1

Fig. 2

Fig. 3

DIN	Fig.	d1	d4	d3	d2	e	β max	Lz min. La=100	Lz min. La= 250
120	3	120	8x8.20	75	101.5	65	25°	430	605
120	3	120	8x10.20	75	101.5	65	25°	430	605
150	3	150	8x10.20	90	130	65	25°	430	605
150	3	150	8x12.20	90	130	65	25°	430	605

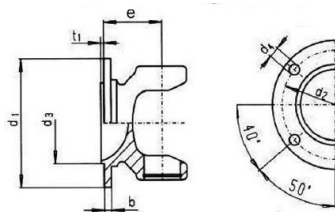

Fig. 4

SAE	Fig.	d1	d4	d3	d2	e	β max.	Lz min. La=100	Lz min. La= 250
1400	4	116	4x12.20	69.85	95.27	65	25°	430	605
1500	4	146	4x14.20	95.25	120.67	51	20°	402	577

MdB= 3500 Nm - MdG= 5000 Nm

Ingombro Rotazione 122 mm

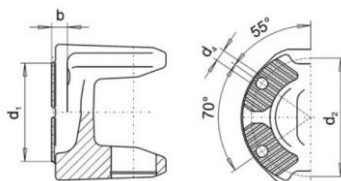
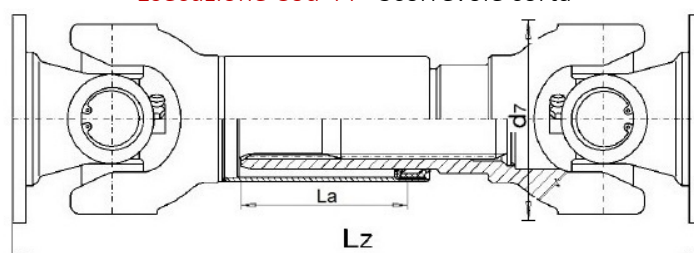

Fig.5

KV	Fig.	d1	d4	d3	d2	E	β max. d6 60	Lz min. La=100	Lz min. La= 250
120	5	120	4x11.10	KV/XS	100	75	25°	450	625
150	5	150	4x13.10	KV/XS	130	63	25°	426	601

Esecuzione Cod 44 - Scorrevole corta



Flangia	Lz minima	La
DIN 120	325	30
DIN 150	325	30
SAE 1400	325	30
SAE 1500	297	30
KV/XS120	245	30
KV/XS150	321	30

Esecuzione Cod 48 - Fissa

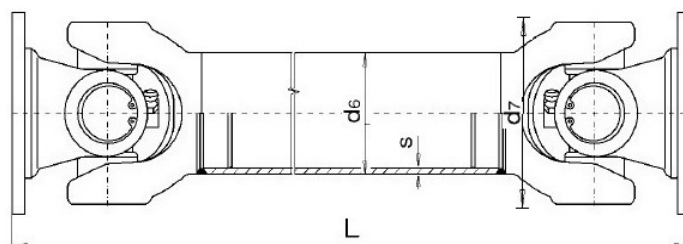

Flangia	L minima	Tubo
DIN 120	306	76.2x2.41 / 88.9x2.41
DIN 150	306	76.2x2.41 / 88.9x2.41
SAE 1400	306	76.2x2.41 / 88.9x2.41
SAE 1500	278	76.2x2.41 / 88.9x2.41
KV/XS120	326	76.2x2.41 / 88.9x2.41
KV/XS150	302	76.2x2.41 / 88.9x2.41

MdB= 3500 Nm - MdG= 5000 Nm

Ingombro Rotazione 122 mm

Esecuzione cod 314 - giunto semplice

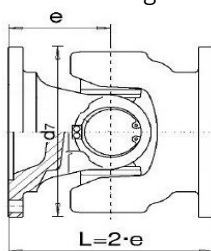

FLANGIA	L
DIN 120	130
DIN 150	130
SAE 1400	130
SAE 1500	102

Esecuzione cod 7675 - giunto doppio

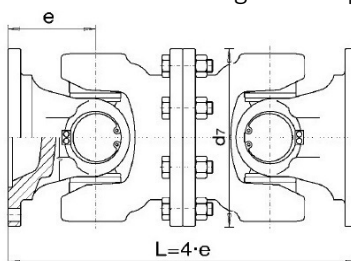

FLANGIA	L
DIN 150	260
SAE 1400	260
SAE 1500	204
DIN 150	260