

MdB= 2400 Nm - MdG= 3500 Nm

Ingombro Rotazione 122 mm

Esecuzione Cod 42	Tubo d6+S
Allungamento Standard La=70 mm e La=100mm	76.2x2.41 / 88.9x2.41 / 100x2.5 / 120x3

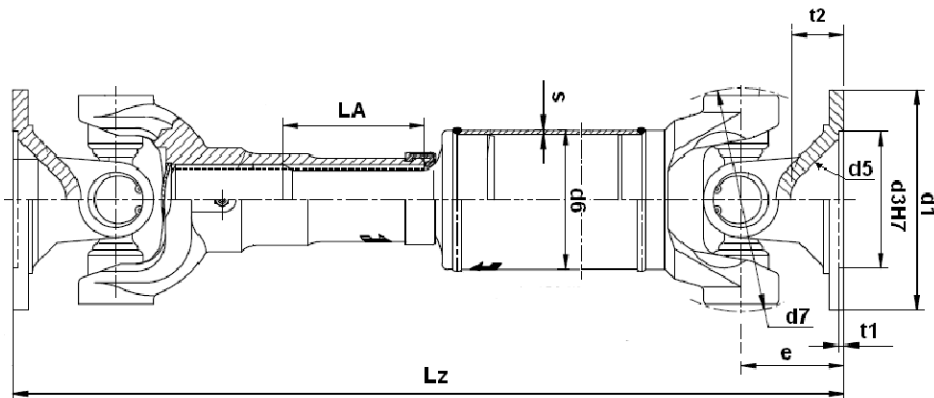

Esecuzione Codice 56	Tubo d6+S
Alto Allungamento La=200 mm e La=250mm	76.2x2.41 / 88.9x2.41 / 100x2.5 / 120x3

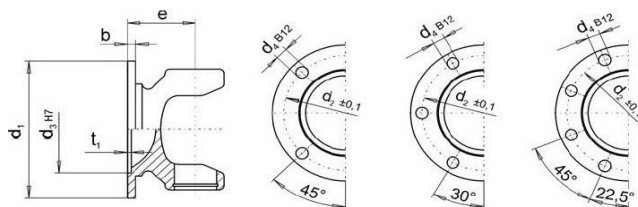
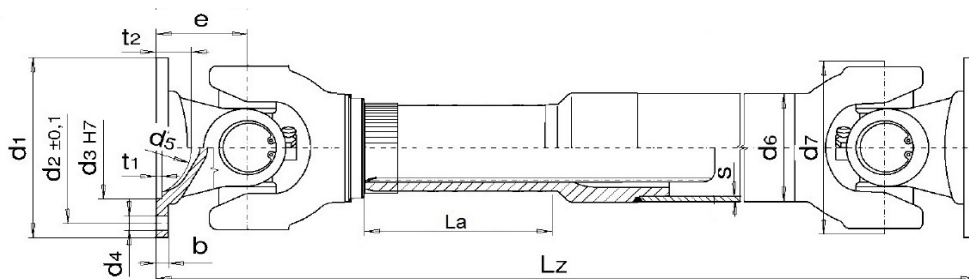

Fig.1

Fig. 2

Fig. 3

DIN	Fig.	d1	d4	d3	d2	e	β max.	Lz min. La=70	Lz min. La=100	Lz min. La=200	Lz min. La= 250
100	2	100	6x8.2	57	84	72	22°	419	454	544	649
120	3	120	8x10.20	64	101.5	56	22°	387	422	512	617
120	3	120	8x10.20	75	101.5	64.5	22°	404	439	529	634

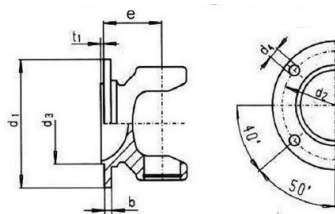

Fig. 4

SAE	Fig.	d1	d4	d3	d2	e	β max.	Lz min. La=70	Lz min. La=100	Lz min. La=200	Lz min. La= 250
1300	4	97	4x10.20	60.32	79.35	64	22°	403	438	528	633
1400	4	116	4x12.20	69.85	95.27	43	22°	361	396	486	591
1500	4	146	4x14.20	95.25	120.67	50.5	22°	376	411	501	606

MdB= 2400 Nm - MdG= 3500 Nm

Ingombro Rotazione 122 mm

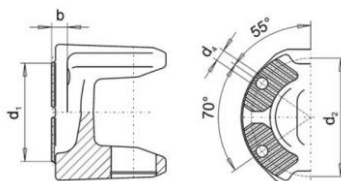
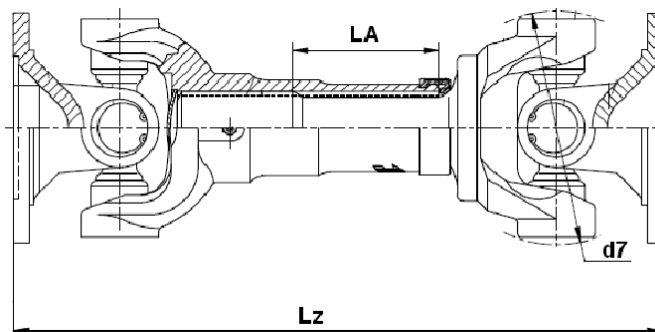

Fig.5

KV/XS	Fig.	d1	d4	d3	d2	e	β max.	Lz min. La=70	Lz min. La=100	Lz min. La=200	Lz min. La= 250
120	5	120	4x11.10	KV/XS	100	69	22°	413	448	538	643
150	5	150	4x13.10	KV/XS	130	65	22°	405	440	530	635

Esecuzione Cod 39 - Scorrevole corta



Flangia	Lz minima	La
DIN 100	314	30
DIN 120	282	30
DIN 120	299	30
SAE 1300	298	30
SAE 1400	256	30
SAE 1500	271	30
KV/XS120	308	30
KV/XS150	300	30

Esecuzione Cod 48 - Fissa

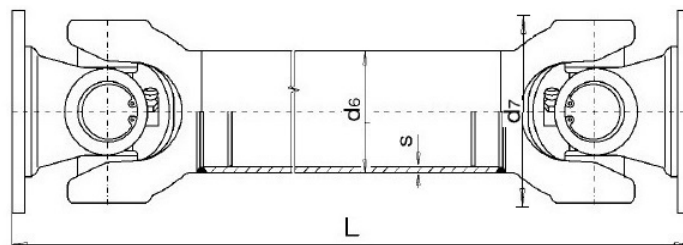

Flangia	L minima	Tubo
DIN 100	284	76.2x2.41 / 88.9x2.41 / 100x2.5 / 120x3
DIN 120	252	76.2x2.41 / 88.9x2.41 / 100x2.5 / 120x3
DIN 120	269	76.2x2.41 / 88.9x2.41 / 100x2.5 / 120x3
SAE 1300	268	76.2x2.41 / 88.9x2.41 / 100x2.5 / 120x3
SAE 1400	226	76.2x2.41 / 88.9x2.41 / 100x2.5 / 120x3
SAE 1500	241	76.2x2.41 / 88.9x2.41 / 100x2.5 / 120x3
KV/XS120	278	76.2x2.41 / 88.9x2.41 / 100x2.5 / 120x3
KV/XS150	270	76.2x2.41 / 88.9x2.41 / 100x2.5 / 120x3

MdB= 2400 Nm - MdG= 3500 Nm

Ingombro Rotazione 122 mm

Esecuzione cod 314 - giunto semplice

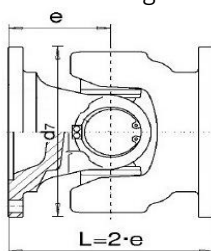

FLANGIA	L
DIN 100	144
DIN 120 H.56	112
DIN 120 H.64.5	129
SAE 1300	128
SAE 1400	86
SAE 1500	101

Esecuzione cod 7675 - giunto doppio

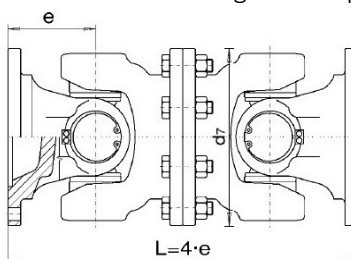

FLANGIA	L
DIN 100	288
DIN 120 H.56	224
DIN 120 H.64.5	258
SAE 1300	256
SAE 1400	172
SAE 1500	202