

MdB= 9500 Nm - MdG= 11700 Nm

Ingombro Rotazione 165mm

Esecuzione Cod 46
Allungamento Standard La=110 mm

Tubo d6+S
120x3

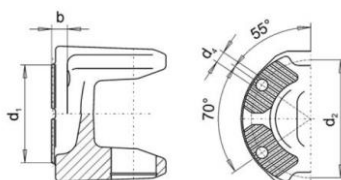
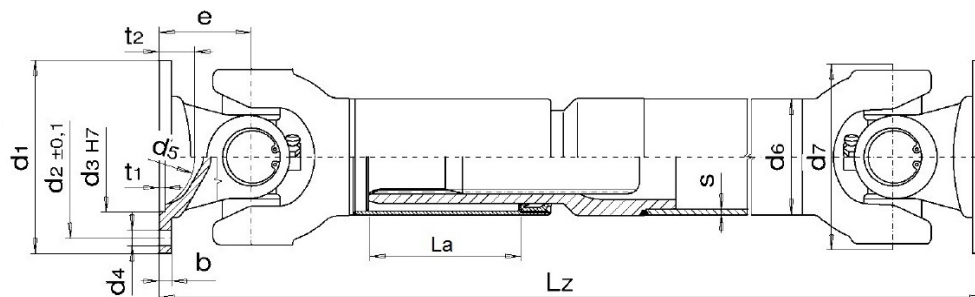

Fig.5

KV	Fig.	d1	d4	d3	d2	e	β max.	Lz min.
150	5	150	4x13.1	KV/XS	130	88.5	30°	686
180	5	180	4x15.1	KV/XS	150	95.5	30°	600