

MdB= 11000 Nm - MdG= 14000 Nm

Ingombro Rotazione 160 mm

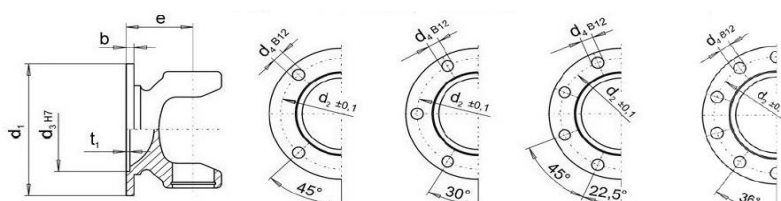
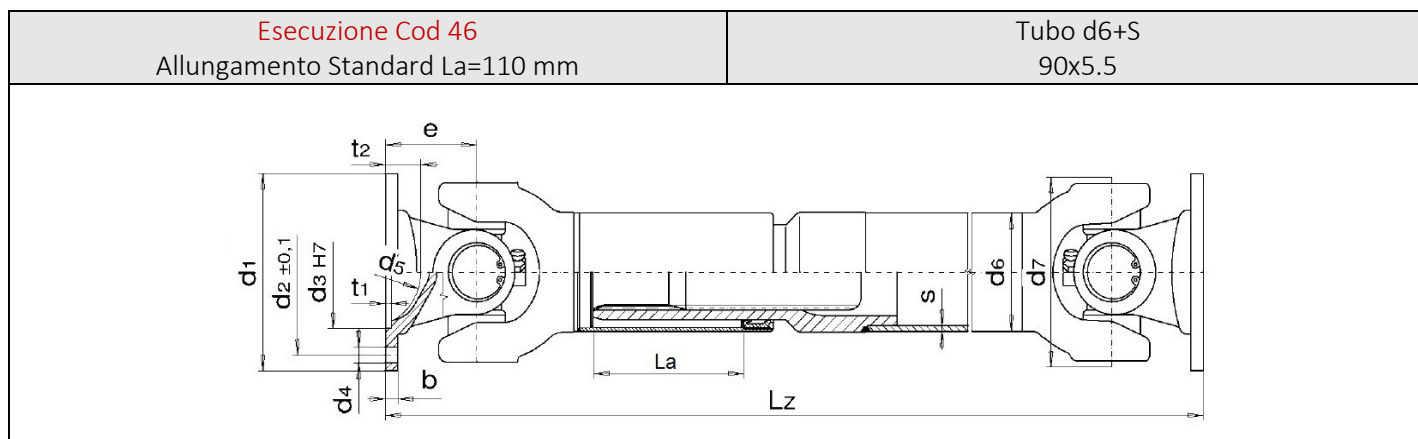

Fig.1

Fig. 2

Fig. 3

Fig.3B

DIN	Fig.	d1	d4	d3	d2	e	β max	Lz min. La=110
150	3	150	8x12.2	90	130	90	32°	595
180	3	180	8x14.2	110	155.5	94	32°	603
180	3	180	8x16.2	110	155.5	94	32°	603
180	3B	180	10x16.2	110	155.5	94	32°	603

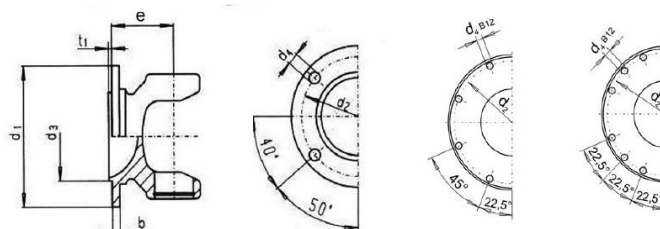

Fig. 4

Fig. 4B

Fig. 4C

SAE	Fig.	d1	d4	d3	d2	e	β max	Lz min. La=110
1600	4B	176	8x10.2	168.22	155.52	91	32°	597
1800	4C	204	12x10.2	196.8	196.8	94.5	32°	604
1800	4C	204	12x11.2	196.8	196.8	94.5	32°	604

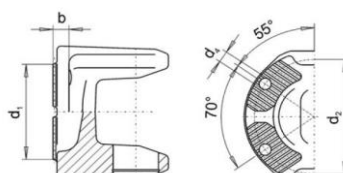

Fig.5

KV	Fig.	d1	d4	d3	d2	e	β max.	Lz min. La=110
150	5	150	4x13.1	KV/XS	130	87	32°	589
180	5	180	4x15.1	KV/XS	150	93.5	32°	602

MdB= 11000 Nm - MdG= 14000 Nm

Ingombro Rotazione 160 mm

### Esecuzione Cod 44 - Scorrevole corta

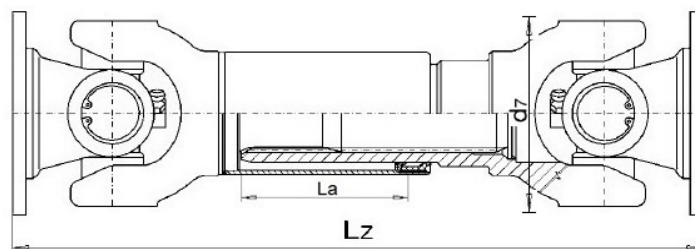

Flangia	Lz minima	La
DIN 150	425	30
DIN 180	433	30
SAE 1500	429	30
SAE 1600	427	30
SAE 1800	434	30
KV/XS150	419	30
KV/XS180	432	30

### Esecuzione Cod 4496 – scorrevole extra corta

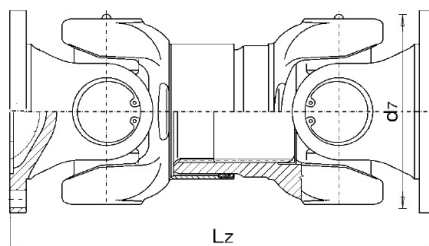

Flangia	L minima	La
DIN 150	356	25
DIN 180	364	25
SAE 1500	360	25
SAE 1600	358	25
SAE 1800	365	25
KV/XS150	320	25
KV/XS150	350	25
KV/XS180	363	25

### Esecuzione Cod 48 - Fissa

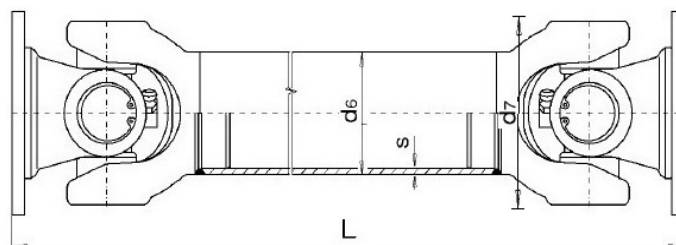

Flangia	L minima	Tube
DIN 150	410	90x5.5
DIN 180	418	90x5.5
SAE 1500	414	90x5.5
SAE 1600	412	90x5.5
SAE 1800	419	90x5.5
KV/XS150	404	90x5.5
KV/XS180	417	90x5.5

MdB= 11000 Nm - MdG= 14000 Nm

Ingombro Rotazione 160 mm

Esecuzione cod 314 - giunto semplice

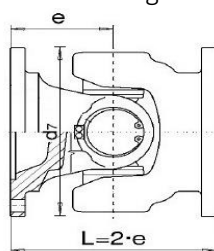

FLANGIA	L
DIN 150	180
DIN 180	188
SAE 1500	184
SAE 1600	182
SAE 1800	189

Esecuzione cod 7675 - giunto doppio

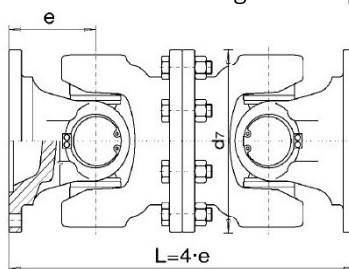

FLANGIA	L
DIN 150	360
DIN 180	376
SAE 1500	368
SAE 1600	364
SAE 1800	378